



Gas Tank 18-072



Tank Emblems 18-073



Fuel Valves 18-073

# 18



Fuel Pump 18-074



Gas Cap & Cover 18-074



Dash & Dash Panel 18-076



Speedo & Tacho 18-077



Drive Unit & Cable 18-078

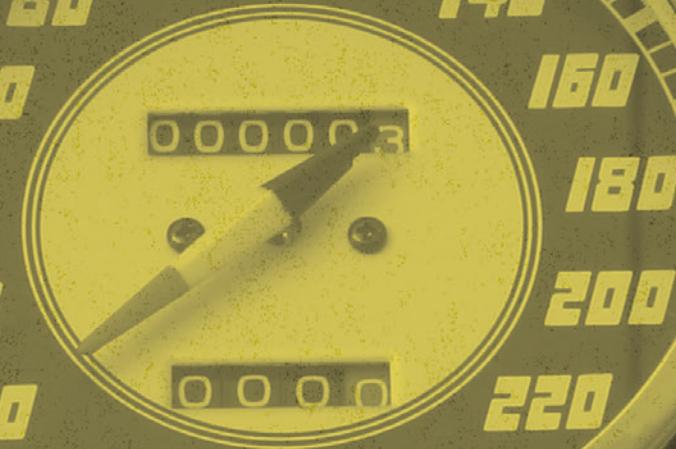

01  
HELMETS,  
LUGGAGE,  
AUDIO & MORE

02  
SEAT

03  
EXHAUST

04  
ELECTRIC  
& LIGHT

05  
ENGINE  
ELECTRICS

06  
INTAKE

07  
ENGINE

08  
PRIMARY

09  
TRANSMISSION

10  
FINAL DRIVE

11  
WHEELS &  
TIRE

12  
BRAKE

13  
FOOT  
CONTROL

14  
HANDLEBAR

15  
FRONT  
SUSPENSION

16  
CHASSIS/  
FRAME  
& SHOCKS

17  
FENDER  
& STRUTS

18  
GAS TANK &  
INSTRUMENT

19  
OIL TANK, FILTER  
& LINE

20  
FASTENERS

21  
MIRROR

22  
WINDSHIELD

23  
OIL, CHEMICALS  
& TOOLS

24  
TECHTIPS &  
CROSS REF  
> ZPN

25  
CROSS REF  
ZPN > PAGE

26  
ALPHABETICAL  
INDEX





### CUSTOM STYLE TANKS WITH DASH MOUNT FOR SOFTAIL TWIN CAM

Custom gas tanks with dash mount for Twin Cam Softail. Can be used with the stock or stock style seats. Made from heavy gauge steel for years of leak and trouble free riding. Tanks are available for use with OEM style Screw-In gas caps and the gauge equipped OEM left side cap, as well as a model with our Quick Cam lockable gas caps on both sides of the tank. Both styles are available for carburetor and EFI models. Tanks take approx. 5.1 gallon (19.3L).

**Note:** Installation on 2004 and later models require a plug ZPN 789782 and ring ZPN 789486. Models 2006 and 2007 require a custom bracket for the fuel level gauge.

### Fits carburetor equipped Twin Cam Softail 2000-2006

**011813** Screw-In style gas caps, caps not included (style B)

**011801** Quick Cam lockable gas caps, caps included (style D)



### Fits Fuel Injection equipped Twin Cam Softail 2001-2007

**011861** Screw-In style gas caps (style B)

### Fits Fuel Injection equipped Twin Cam Softail 2008-2017

**012910** For use with OEM or stock-style gas cap and fuel gauge or dummy cap (style B)

**012912** Adapter plate for 2008 and later style fuel gauge

### Required parts:

**789482** Fuel manifold plug (OEM 62843-00)

**789486** O-ring, 2-pack (OEM 11323)



### 2" STRETCHED CUSTOM STYLE TANKS WITH DASH MOUNT FOR SOFTAIL TWIN CAM

This one-piece stretched gas tank has a proper dash mount and will give your Softail a longer, stretched look. This tank will change the appearance of your bike. Due to the stretch these tanks must be used with a Custom seat. Tanks are available for use with OEM style Screw-In style gas caps on the right hand side and fuel gauge on the left side. For those who can do without this gauge we have a tank available that uses our Quick Cam lockable gas caps on both sides. Tanks take approx. 5.1 gallon (19.3L) of fuel.

**Note:** Installation on 2004 and later models require a plug ZPN789782 and ring ZPN789486. Models 2006 and 2007 require a custom bracket for the fuel level gauge.

### Fits carburetor equipped Twin Cam Softail 2000-2006, except FXSTD

**011814** For use with OEM or stock-style gas cap and fuel gauge or dummy cap (style B)

**011807** For use with Quick Cam lockable gas caps. Order gas cap set ZPN 011549 separately (style D)



### Fits Fuel Injection equipped Twin Cam Softail 2001-2007, except FXSTD

**011864** For use with OEM or stock-style gas cap and fuel gauge or dummy cap (style B)

### Fits Fuel Injection equipped Twin Cam Softail models 2008 thru 2017, except FXCW, FXCWC, FXS and FXSB

**012911** For use with OEM or stock-style gas cap and fuel gauge or dummy cap (style B)

### Required parts:

**789482** Fuel manifold plug (OEM 62843-00)

**789486** O-ring, 2-pack (OEM 11323)

**NEW**



### MUSTANG LAREDO STYLE GAS TANKS

Mustang Laredo style steel gas tank as we have used it on our "Captain Larry". Tanks hold 3.1 Gallon (11.5L), are 17" (43cm) long, 11 1/2" (29cm) wide, have a 2" (5cm) wide low tunnel and a 3/8 NPT right center petcock opening, as well as rear left and right 1/4 NPT connections. Has universal brackets that makes it easy to mount it to almost any stock or custom frame. Like all Zodiac gas tanks these are made from heavy gauge steel. The Mustang Laredo style ribbed gas tank for example weighs in at 3.25kg (7.2 Lbs).

### Mustang Laredo style ribbed gas tanks with dished sides

**012980** With right side bung for 1983-2017 screw-in style gas cap (style B)

**012981** With right side bung for cam lock style gas cap (style A)

**012982** With right side bung complete with chrome pop-up style gas cap (style G)

### Mustang Laredo style gas tanks with dished sides

**012986** With right side bung for 1983-2017 screw-in style gas cap (style B)

**012987** With right side bung for cam lock style gas cap (style A)

**012988** With right side bung complete with chrome pop-up style gas cap (style G)

**012983** With center bung for 1983-2017 screw-in style gas cap (style B)

**012984** With center bung for cam lock style gas cap (style A)

**012985** With center bung complete with chrome pop-up style gas cap (style G)



Genuine Zodiac gas tanks including their brackets are made from the same or heavier gauge steel as genuine tanks, your guarantee for years and years of reliable service. Feel free to compare the weight of these quality products with cheap imitations.

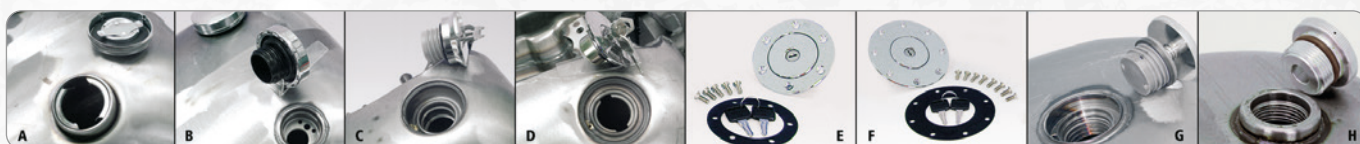





### VINTAGE CAUTION & DATA PLATES

Perfect for restoration of ELC, WLA, WLC and even the shaft driven XA models, these metal plates are the real thing. Mount to your bike for those true authentic looks.

- A. 745883** Brass caution plate for late 1942 WLA (OEM 3531-42M)
- B. 745882** Brass data plate for 1940 WLA (OEM 3531-40M)
- C. 745884** Data plate for 1944-1945 WLA (OEM 3531-44M)
- D. 745881** Brass caution plate for late 1942 and early 1943 WLC (OEM 3531-41M)
- E. 745885** Zinc data plate for 1943 WLC
- F. 745886** Brass caution plate for 1942 XA models (OEM 61550-42)
- G. 745888** Brass caution plate for ELC Military Knucklehead
- H. 762655** Brass caution plate for 1941 and early 1942 WLA (OEM 3531-41M)
- I. 762654** Brass caution plate for mid 1942 WLC (OEM 3531-41M)



### IN-LINE FUEL VALVES

Fuel valves, also known as petcocks, precision made from solid brass. Have open and closed positions only, no reserve.

- 022642** Polished brass
- 022640** Chrome
- 022641** Black

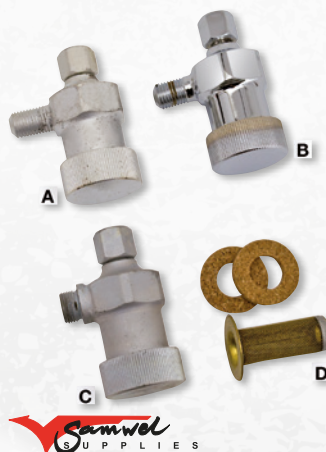

### GAS STRAINERS FOR VINTAGE MODELS

Perfect copies of the gas strainers as found on 1942 thru 1965 45CI and Big Twin models. Gas strainers come complete with the lower cap. Screen and seal kit must be ordered separately.

- A. 745904** Gas strainer without screen, fits all 1942 thru 1949 models (OEM 62250-41)
- A. 760013** Gas strainer without screen, fits all 1942-1949 models but has non-stock barb fittings for regular fuel hose
- B. 745905** Chrome gas strainer without screen, fits all 1942 thru 1949 models (OEM 62250-41)
- C. 745906** Gas strainer without screen, fits all 1950 thru 1965 models (OEM 62250-50)
- D. 745907** Screen and seal kit for all above gas strainers, also fits all 1932 thru 1938 models (OEM 62265-32 & 2 pcs. 62270-32)
- 781646** Rubber/cork blend seal washer, James, 10-pack (OEM 62270-32)



### GAS LINES FOR VINTAGE MODELS

Replica steel tank-to-carburetor and tank-to-tank (also known as crossover) lines with a tin finish and fitted connector like stock. Consequently, for 1950-1965 Big Twin tank-to-carb lines nuts and seals must be ordered separately. Selected lines also available in chrome.

### Tank-to-carburetor lines for Sidevalve models

- 745902** Fits all 1942-1949 45CI models, Samwel (OEM 3607-41M & 62354-42)
- 745903** Chrome, fits all 1942-1949 45CI models, Samwel (OEM 3607-41M & 62354-42)
- 758357** Tin finish gas feed line, fits 1937-1938 U, UL & ULH Flathead, V-Twin Mfg. (OEM 3607-37)
- 758358** Tin finish gas feed line, fits 1939 U, UL & ULH Flathead, V-Twin Mfg. (OEM 3608-39)
- 758359** Tin finish gas feed line, fits 1940-1941 U, UL & ULH Flathead, V-Twin Mfg. (OEM 3608-40 & 62353-40)
- 758360** Fits 1942-1948 U, UL & ULH Flathead, tin finish, V-Twin Mfg. (OEM 3608-42 & 62353-42)
- 782996** Flexible black cotton braided as stock on WLC, fits all 1942 thru 1949 45CI models, Samwel (OEM 3607-41B)

### Tank-to-tank lines

- 758353** Crossover line, fits all 1940-1947 Big Twin, tin finish, V-Twin Mfg. (OEM 62355-40)
- 758354** Crossover line, 1948 style, fits 1948-1965 Big Twin, tin finish, V-Twin Mfg. (OEM 62355-48)
- 012251** Crossover line, 1948 style, fits 1948-1965 Big Twin, chrome, Genuine Zodiac (OEM 62355-48)
- 758355** Crossover line, 1949-1956 style, fits 1948-1965 Big Twin, tin finish, V-Twin Mfg. (OEM 62355-48A)
- 758356** Crossover line, 1957-1965 style, fits 1948-1965 Big Twin, tin finish, V-Twin Mfg. (OEM 62355-48B)

### Tank-to-carburetor lines for OHV models

- 758361** Fits 1936-1938 E & EL Knucklehead, V-Twin Mfg. (OEM 3607-36)
- 758362** Fits 1939 E & EL Knucklehead, tin finish, V-Twin Mfg. (OEM 3607-39)
- 758363** Fits 1940-1941 E, EL & F, FL & FLH Knucklehead, tin finish, V-Twin Mfg. (OEM 3607-40 & 62352-40)
- 758364** Fits 1942-1948 E, EL & F, FL & FLH Knucklehead & 1948-1949 Panhead, tin finish, V-Twin Mfg. (OEM 3607-41A & 62352-41)
- 758365** Fits 1950-1965 F, FL & FLH Panhead, tin finish. Comes without nuts and seals, V-Twin Mfg. (OEM 62352-50)
- 758366** Fuel line nut, cad plated, set of 2, V-Twin Mfg. (OEM 62361-50)
- 758367** Fuel line seal, set of 2, V-Twin Mfg. (OEM 62360-50)
- 758368** Fuel line seal, set of 10, Genuine James (OEM 62360-50)

01  
HELMETS,  
LUGGAGE,  
AUDIO & MORE

02  
SEAT

03  
EXHAUST

04  
ELECTRIC  
& LIGHT

05  
ENGINE  
ELECTRICS

06  
INTAKE

07  
ENGINE

08  
PRIMARY

09  
TRANSMISSION

10  
FINAL DRIVE

11  
WHEELS &  
TIRE

12  
BRAKE

13  
FOOT  
CONTROL

14  
HANDLEBAR

15  
FRONT  
SUSPENSION

16  
CHASSIS/  
FRAME  
& SHOCKS

17  
FENDER  
& STRUTS

18  
GAS TANK &  
INSTRUMENT

19  
OIL TANK, FILTER  
& LINE

20  
FASTENERS

21  
MIRROR

22  
WINDSHIELD

23  
OIL, CHEMICALS  
& TOOLS

24  
TECHTIPS &  
CROSS REF  
> ZPN

25  
CROSS REF  
ZPN > PAGE

26  
ALPHABETICAL  
INDEX





## FUEL CHECK VALVES

Stock replacement check valves as found inside the gas tank of Fuel Injected models.

- A. 749417** Fits 2000-2002 Fuel Injected Touring, each (OEM 61408-00A)
- B. 749416** Fits 2003-2007 Fuel Injected Touring, each (OEM 62228-03)
- C. 749415** Fits 2008-2017 Fuel Injected Touring & Trike, each (OEM 62228-08C)
- D. 749412** Fits 2004-2017 Fuel Injected Dyna, each (OEM 62194-04D)
- E. 749414** Fits 2001-2007 Fuel Injected Softail, each (OEM 62189-01A)
- F. 749413** Fits 2007-2017 Fuel Injected Softail, each (OEM 62189-08B)



## GAS CAP & OIL CAP SEALS FOR VINTAGE MODELS

European made cork seal for the left side gas cap and genuine leather seal for the right side oil cap as originally used on 45CI models.

- 780296** Cork gas cap seal and genuine leather oil cap seal (OEM 3509-36, 3509-36A, 61112-37)

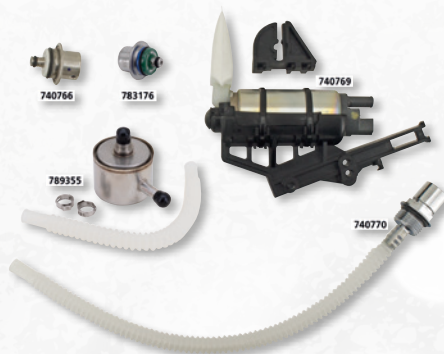

## FUEL PUMP PARTS

Replacement parts for fuel pumps on Delphi Fuel Injected models.

- 740766** Fuel pressure regulator, 400KPH, 2002-2007 Touring, 2001-2007 Softail, 2002-2017 V-Rod (OEM 27408-01)
- 758540** Fuel pressure regulator, 2004-2017 Dyna, 2008-2017 Softail, 2008 to present Touring, 2007 to present Sportster (OEM 61015-04A)
- 789355** Fuel filter with clamps, O-ring and hose, 2002 thru 2007 Touring and 2001 thru 2007 Softail, V-Twin Mfg. (OEM 61001-01)
- 740769** Fuel pump assembly, 2002 thru 2007 Touring and 2001 thru 2007 Softail (OEM 62897-01B)
- 740770** Check valve assembly with O-ring, 2001 thru 2007 Softail (OEM 62189-01A)
- 783176** Fuel pressure regulator, 400KPH, V-Twin Mfg., 2002-2007 Touring, 2001-2007 Softail, 2002-2017 V-Rod (OEM 27408-01)



## TANK CAPS FOR WLC

Chained Eaton type gas- and oil tank cap in genuine "olive drab" green as used on WLC Army models. Can also be used on all other 1936-early 1973 Harley-Davidson models.

- 762652** Gas cap (OEM 3507-41B)
- 762653** Oil tank cap (OEM 3507-41A)

## Replacement parts

- 780296** Cork gas cap seal and genuine leather oil cap seal (OEM 3509-36, 3509-36A, 61112-37)



## FUEL GAUGE SENDER UNITS

Fuel gauge sender units as originally fitted in the gas tank are digitally calibrated for accuracy. Main picture shows ZPN 789900.

## Dyna models

- 781340** Fits 2004-2008 Dyna (OEM 75219-04)
- 781341** Fits 2009-2017 Dyna (OEM 75219-09)

## Touring models

- 789894** Fits 1988-1994 FLT (OEM 75040-88A)
- 789890** Fits 1995-1996 Fuel Injected (OEM 75071-95)
- 789895** Fits 1997-1999 carbureted FLT & FLHT, 2001 FLHT, FLHTC, FLTR, (OEM 75040-01, 75040-97B)
- 789896** Fits 2000-2001 fuel injected FLHR, FLHRC (OEM 75139-00)
- 789897** Fits 2000-2001 FLHT (OEM 75071-00A)
- 789891** Fits 2002-2005 carbureted FLHT & FLTR (OEM 75071-02)
- 789892** Fits 2002-2005 carbureted FLHR & FLHRC Road King (OEM 75205-02)

## FXR models

- 789898** Fits 1982-1987 FXR models (OEM 75034-82)

## Softail models

- 789899** Fits 2001 Fuel Injected Softail (OEM 75142-01A)
- 789900** Fits 2002-2005 Fuel Injected Softail (OEM 75208-02, 75300-05)





### RSD GAS CAPS & FUEL GAUGE REPLACEMENT CAPS

Roland Sands has packed as much style as he could into his RSD gas cap line. Each design is unique and with over a dozen to choose from, there is sure to be one to match your style. They come as crew-in style vented gas caps that fit all models 1996 to present or as a Dummy Cap to replace the stock fuel gauge or as a LED indicator cap. This is a direct replacement snap-in cap to replace the left side OEM fuel gauge with a built in Low Fuel LED light built in. The light is user programmable to any pre-set fuel level. Except for the Vintage design these caps come with an interchangeable RSD logo in contrast cut black or black and brass. Available in chrome, RSD's exclusive Black OPS or Contrast Cut black.



#### Vented gas caps 1996-2017

Chrome	Black OPS	Contrast Cut	
-	740881	740876	Café
743300	743301	743299	Gear Drive
-	743304	743302	Misano
-	740884	740882	Radial
-	740887	740885	Tech
-	752075	740625	Tracker
-			Vintage

#### Vented gas caps 1996 to present

Chrome	Black OPS	Contrast Cut	
-	747399	-	Café
-	-	747398	Gear Drive

#### Fuel Gauge replacement caps

Chrome	Black OPS	Contrast Cut	
740863	740864	740862	Café
-	740867	-	Gear Drive
740869	740870	-	Tech
740872	-	-	Tracker



#### LED Fuel level indicator Caps

Chrome	Black OPS	Contrast Cut	
752034	-	-	Gear Drive
-	743298	743296	Misano
752037	-	-	Tech
-	-	752039	Tracker
752043	752044	-	Vintage

01  
HELMETS,  
LUGGAGE,  
AUDIO & MORE02  
SEAT03  
EXHAUST04  
ELECTRIC  
& LIGHT05  
ENGINE  
ELECTRICS06  
INTAKE07  
ENGINE08  
PRIMARY09  
TRANSMISSION10  
FINAL DRIVE11  
WHEELS &  
TIRE12  
BRAKE13  
FOOT  
CONTROL14  
HANDLEBAR15  
FRONT  
SUSPENSION16  
CHASSIS/  
FRAME  
& SHOCKS17  
FENDER  
& STRUTS18  
GAS TANK &  
INSTRUMENT19  
OIL TANK, FILTER  
& LINE20  
FASTENERS21  
MIRROR22  
WINDSHIELD23  
OIL, CHEMICALS  
& TOOLS24  
TECHTIPS &  
CROSS REF  
> ZPN25  
CROSS REF  
ZPN > PAGE26  
ALPHABETICAL  
INDEX



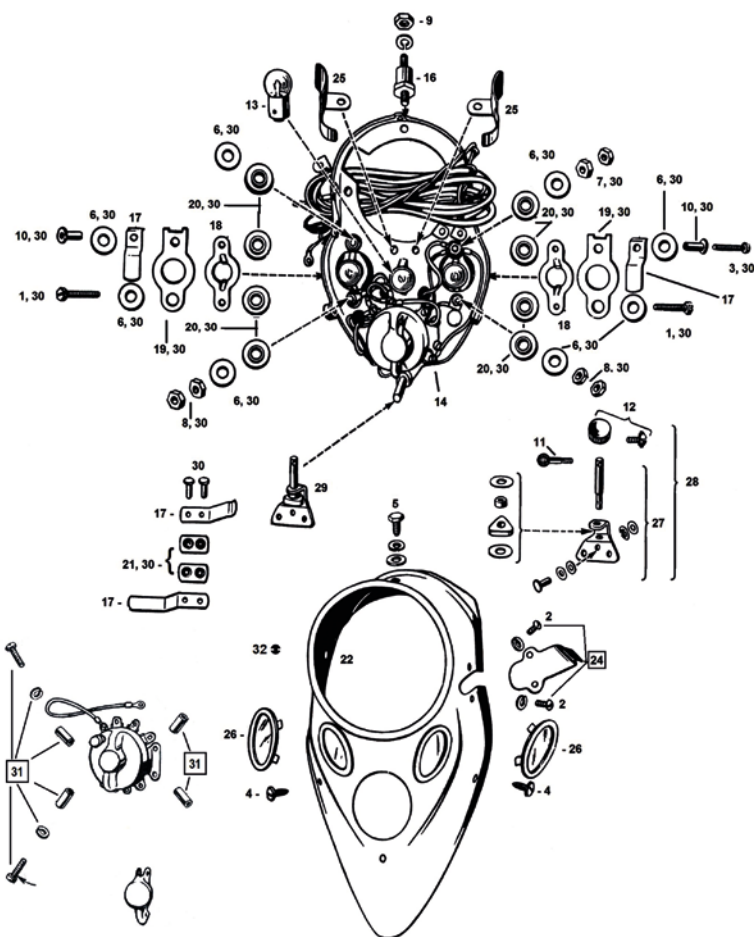

Pos.	ZPN.	Description	OEM
24.	780287	Cover with trip reset hole and chrome screws, 1939-1946	71313-39
25.	232191	Left and right panel light shields, all 1939 thru 1946 models	71325-39 & 71326-39
26.	745936	Set of instrument panel windows with chrome frame	71338-39, 71340-39 & 74341-36
26.	782941	Set of instrument panel windows with black frame	71338-39, 71340-39 & 74341-36
	780245	Set of blackout windows, army models	4524-41M
27.	231236	Panel light switch 1939-1946, Colony	71600-39
27.	745938	Panel light switch 1939-1946, Samwel	71600-39
28.		Panel light switch with knob, 1939-1946, Samwel	71600-39 & 71610-42
29.	232965	Panel light switch 1937-1938 Big Twin	71601-37
30.	237626	Colony 36 pcs. dash base restoration kit with riveting tool, includes: Pos. 1, 3, 6, 7, 8, 10, 19, 20, 21, 30	
31.	782799	Colony 12-piece switch mount kit for WLA with blackout feature	4560-41MA
32.	780285	Cover plug, left	4518-38

## INSTRUMENT PANEL 1937-1946

Pos.	ZPN.	Description	OEM	Pos.	ZPN.	Description	OEM
1.	762605	Bulb socket screw #8-32x3/4", 10-pack	1070		780248	Panel lamp bulb, all 1937-1946, 12 Volt, 10-pack	-
2.	762612	Fillister head screw #10-32x3/8", cad plated, 10-pack	1190	14.	013066	Instrument panel base kit, all 1939-1946	70935-39
2.	762613	Fillister head screw #10-32x3/8", chrome, 10-pack	1190	14.	769038	Replica panel base kit, all 1939-1945	70935-39
3.	-	Bulb socket screw #6-32x7/8"	2598	15.	-	Panel base only, all 1939-1946	70950-39
4.	780291	Panel cover self tapping screws, pair	2658	16.	-	Mounting base stud, all 1937-1946	71065-36
5.	780292	Panel cover hex screw #10-32x5/16"	3550	17.	237494	Dash base contact spring kit, Colony	71093-36, 2x 71093-38 & 71607-37
6.	-	3/16"x7/16"x1/32" steel washer (8)	6182	18.	237493	Dash base side bulb contact springs	71095-38
7.	-	Socket screw nut #6-32	7590	19.	-	Bulb socket insulator	71097-38
8.	-	Socket screw nut #8-32	7608	20.	-	Screw insulator	71098-38
9.	239884	1/4-24 nut, parkerized, all 1937-1946	7691	21.	-	Center contact spring insulator	71180-36
10.	-	Instrument panel lamp socket rivet	8515	22.	013064	Chrome Cat-Eye dash cover with lenses, made in Taiwan	71270-39
11.	232966	Switch stem handle, 1937-1938 Big Twin	4556-37	22.	781188	Chrome Cat-Eye dash cover with lenses, V-Twin Mfg.	71270-39
12.	232952	Domed panel switch knob & screw, 1939 thru early 1943, chrome	4556-39	22.	781189	Black Cat-Eye dash cover with lenses, V-Twin Mfg.	71270-39
12.	232954	Domed panel switch knob & screw, 1939 thru early 1943, parkerized	4556-39	22.	789920	1939-1942 replica black Cat-Eye dash cover with lenses, V-Twin Mfg.	71270-39
12.	232958	Flat panel switch knob & screw, late 1943 thru 1946, chrome	71610-42	23.	-	Instrument panel cover plug	71310-38
12.	232964	Flat panel switch knob & screw, late 1943 thru 1946, parkerized	71610-42	24.	-	Cover side plate 1939-1946	71311-39
13.	780247	Panel lamp bulb, all 1937-1946, 6 Volt, 10-pack	68165-15	24.	780286	Cover with trip reset hole and white plated screws, 1939-1946	71313-39
				24.	780288	Cover with trip reset hole and parkerized screws, 1939-1946	71313-39



## REPLICA 1939-1942 STYLE CAT EYE DASH COVER

An exact replica from the highly sought after Cat-Eye dash with the raised v-pattern in the switch area as on the 1939 thru early 1942 models. Comes complete with lenses, side plate and trim. Also fits 1937-1938 and late 1942-1946 models.

**789920** Replica 1939-early 1942 dash cover, black (OEM 4516-39 & 71270-39)





## TOMMY & SONS

### TOMMY & SONS DASH COVERS FOR TOURING

Super sleek looking dash panels made from fiberglass in precision build moulds by Tommy & Sons. They come with a white gel coat finish, ready for your painter's preparation.



**761102** For Tommy & Sons Rocca tank shrouds on 1993-2007 Touring

**761103** For Tommy & Sons Rocca and Celtic tank shrouds on 2009 to present Touring, except Road King



**761155** For Tommy & Sons Rocca and Celtic tank shrouds on 2009-2017 Road King



### INSTRUMENT BRACKETS FOR SPORTSTER, DYNA & POLICE ROAD KING

These brackets bolt to the stock handlebar clamp on 1995 to 2005 XL 883 Sportster and 1995 thru 2004 FXD Super Glides and 1996 thru 2013 Road Kings. Also fits 2004 thru 2017 Dyna models when installed in conjunction of an aftermarket handlebar clamp. Takes all speedo's and tachos with 3 1/2" (89mm) housing, referred by Harley as 4" gauges. Has five control light holes.

### Single gauge brackets

**169387** Chrome (OEM 67293-95)

**169388** Black (OEM 67053-95)



### Dual gauge brackets

**169389** Chrome

**169390** Black (OEM 67110-95)

### Accessories

**789487** Rubber cushion for speedo or tacho (OEM 67121-95A)



### STOCK STYLE ELECTRONIC SPEEDO 1996-2003

Electronic controlled black faced speedo with digital odometer for use on 1996-2003 Softail, Road King and FXDWG Dyna Wide Glide models that are equipped with the stock transmission fitted electronic speed sensor pick up. Meter is 4 1/2" (11.5cm) in diameter, fits stock dash and features the direct-plug in terminal as found on 1999-2003 models. Installation on 1996-1998 models requires either re-use of the wiring harness from the stock speedometer and crimping of our 12-pin connector kit ZPN701626 to this, or a model-specific Plug & Play connector kit.

**169081** Electronic KM/H speedo (OEM 67197-99A)

**169055** Electronic MPH speedo (OEM 67027-99A)

**701626** Speedo connector kit (OEM 74119-98BK, 74159-98, 74191-98 & 74195-98)

**701822** Plug & Play connector kit for 1996-1998 Softail

**701825** Plug & Play connector kit for 1996-1997 FLHR Road King

**701823** Plug & Play connector kit for 1996-1997 FXDWG Dyna Wide Glide

**701824** Plug & Play connector kit for 1998 FLHR Road King & 1998 FXDWG Dyna Wide Glide



### RICK'S SPEEDOMETER HOUSINGS FOR SPORTSTER

These billet aluminum housings change the looks of your speedo from plain-Jane into really Sporty. Housings are black anodized and lower the headlight 2" (5cm), giving a cleaner look on the handlebar and especially smaller riders will value the better view on the road in front. Housings take the stock speedometer and control lights. Easy to install with the included hardware

**757412** Fits 2009 to present XL883N & XL1200NS Iron

**757413** Fits 2016 to present XL1200 CX Roadster



**782983**

### SAMWEL REPLICA SPEEDO FACEPLATE FOR VINTAGE MODELS

Replica faceplates for the OEM Stewart-Warner style speedometers will also fit replica speedos with minor modifications. Well suited for a restoration to replace sun-faded and hardly legible faceplates. Order face plate and brass mounting rivets separately.

**782979** Faceplate for 1938-1940 style speedo, silver, MPH

**782980** Faceplate for 1941-1945 style speedo, black and silver, MPH

**782981** Faceplate for 1941-1945 style speedo, military green, MPH

**782982** Faceplate for 1946-1947 style speedo, black and silver, MPH

**782983** Set of four brass mounting rivets

01  
HELMETS,  
LUGGAGE,  
AUDIO & MORE

02  
SEAT

03  
EXHAUST

04  
ELECTRIC  
& LIGHT

05  
ENGINE  
ELECTRICS

06  
INTAKE

07  
ENGINE

08  
PRIMARY

09  
TRANSMISSION

10  
FINAL DRIVE

11  
WHEELS &  
TIRE

12  
BRAKE

13  
FOOT  
CONTROL

14  
HANDLEBAR

15  
FRONT  
SUSPENSION

16  
CHASSIS/  
FRAME &  
SHOCKS

17  
FENDER  
& STRUTS

18  
GAS TANK &  
INSTRUMENT

19  
OIL TANK, FILTER  
& LINE

20  
FASTENERS

21  
MIRROR

22  
WINDSHIELD

23  
OIL, CHEMICALS  
& TOOLS

24  
TECHTIPS &  
CROSS REF  
> ZPN

25  
CROSS REF  
ZPN > PAGE

26  
ALPHABETICAL  
INDEX





**Vity's**  
DESIGN

## VITY'S BILLET INSTRUMENT HOUSINGS

These instrument housings and riser sets are made and designed in Italy and take the stock instruments. Both housings and risers are rake-adjustable to give the best feel and view. Instrument housing and riser sets are sold individually.



- 780650** Black anodized instrument housing for 2015 to present Road Glide models
- 780651** Silver anodized instrument housing for 2015 to present Road Glide models
- 780652** Black anodized instrument housing for 2018 to present FXLR & FXLRS Low Rider
- 780653** Silver anodized instrument housing for 2018 to present FXLR & FXLRS Low Rider
- 780644** Adjustable riser set, 10" high, black anodized
- 780645** Adjustable riser set, 10" high, silver anodized
- 780646** Adjustable riser set, 10" high, gold anodized
- 780647** Adjustable riser set, 10" high, blue anodized
- 780648** Adjustable riser set, 10" high, red anodized
- 780649** Adjustable riser set, 10" high, purple anodized



**Barnett**  
Cables & Cables

## BARNETT SPEEDO & TACHO METER CABLES

Speedometer cables for front wheel drive all have the same lower connection. Stock applications are listed with length and top nut specified to allow you to select a longer or shorter version or use with non-stock instruments.

### Speedo cable, front wheel driven.

**Fits 1983-1985 XLX, 1983-1984 XR1000, 1980-1982 FXB, 1973-early 1984 FXE, 1979-1984 FXEF, 1986-1984 FXLR, 1986-1994 FXR, 1985 FXRP, 1984-1987 FXRS, 1977-1984 FXS, 1983-1985 FXSB, 1997-1999 FLTR**

**789861** Black speedo cable, L= 40" (102cm) with 16mm speedo nut (OEM 67051-73, 67052-78A, 67063-89, 67077-85, 67078-85A)

### Speedo cable, front wheel driven.

**Fits 1973 XL, late 1984-1985 XLS, all 1986-1984 XL, 1996-up FLHT, 1990-1994 FXRS-CON, 1985-1993 FXRSP, 1985 FXRT, 1985-1987 FXRC, 1986-1985 FXRP, 1978-1982 FX, 1982-1984 FXSB, 1984-1987 FXRS**

**789862** Black speedo cable, L= 43" (109cm) with 16mm speedo nut (OEM 67048-83A, 67052-78B, 67060-96, 67063-89)

### Speedo cable, front wheel driven.

**Fits 1983 XLS, 1986 FXRD, 1984 FXRDG, 1983-1984 FXRT, 1986-1994 FXRT, 1986 FXWG**

**789863** Black speedo cable, L= 47" (119cm) with 16mm speedo nut (OEM 67054-83B)

### Speedo cable, front wheel driven.

**Fits 1974-1979 XLCH, 1977-1978 XLCR, 1974-1983 XLH, 1977 XLT, 1979-1982 XLS, 1983-1985 FLHT, 1980-1985 FLHTC, 1987-1995 FLHTC, 1989-1995 FLHTCU, 1995 FLHTCUI, 1989-1995 FLHTP, 1984-1985 FLHTP, 1987-1995 FLHTP, 1980-1983 FLT, 1980-1986 FLTC, 1989-1995 FLTCU, 1993-1995 FXDWG, 1984-1990 FXST, 1986-1995 FXSTC, 1988-1996 FXSTS, 1995 FXSTSB, 1984-1985 FXWG, 1982-1983 FXR, 1984 FXRP, 1982-1983 FXRS, 1991-1995 FXDG. Also fits MMB and Zodiac Mini speedos**

**789864** Black speedo cable, L= 40" (102cm) with M12-1 speedo nut (OEM 67024-84A, 67038-84, 67051-74, 67060-79B, 67060-87A, 67072-79, 67186-88)

### Speedo cable, front wheel driven.

**Fits 1981-1984 FL, 1987-1994 FLHS, 1986-1990 FLST, 1987-1995 FLSTC, 1990-1995 FLSTF, 1993-1995 FLSTN, 1987-1995 FLTC, 1987-1995 FLTCU, 1996 FLTCUI, 1992 FXDBD, 1991 FXDBS, 1992 FXDC, 1993-1994 FXDL, 1988-1992 FXRS. Also fits MMB and Zodiac Mini speedos**

**789865** Black speedo cable, L= 36" (91cm) with M12-1 speedo nut (OEM 67026-81, 67072-87B, 67079-86A)

### Speedo cable, transmission driven.

**Fits all 1937-1984 Big Twin**

**789866** Black speedo cable, L= 36" (91cm) with 5/8"-18 speedo nut (OEM 67026-37, 67026-62)

### Speedo cable, transmission driven.

**Fits all 1952-1956 K models and all 1957-1969 Sportster**

**789867** Black speedo cable, L= 46" (117cm) with 5/8"-18 speedo nut (OEM 67051-52A)

### Speedo cable, transmission driven.

**Fits all 1970-1972 Sportster**

**789868** Black speedo cable, L= 46" (117cm) with 16mm speedo nut (OEM 67051-70, 67055-70)

### Tachometer cable.

**Fits all 1974-1980 Sportster**

**789869** Black tachometer cable, L= 33" (84cm) with 12mm engine side nut and M12-1 speedo nut (OEM 92065-74)

### Tachometer cable.

**Fits all 1970-1973 Sportster**

**789870** Black tachometer cable, L= 32" (81cm) with 12mm engine side nut and 16mm speedo nut (OEM 92065-70)

### Speedo cable, front wheel driven.

**Fits 1998-1999 FLHT, FLHTC, FLHTCI & FLHTCUI**

**789871** Black speedo cable (OEM 67054-98)