

056025

FORWARD CONTROL SET FOR SPORTSTER 4-SPEED MODELS 1986 THRU 1990

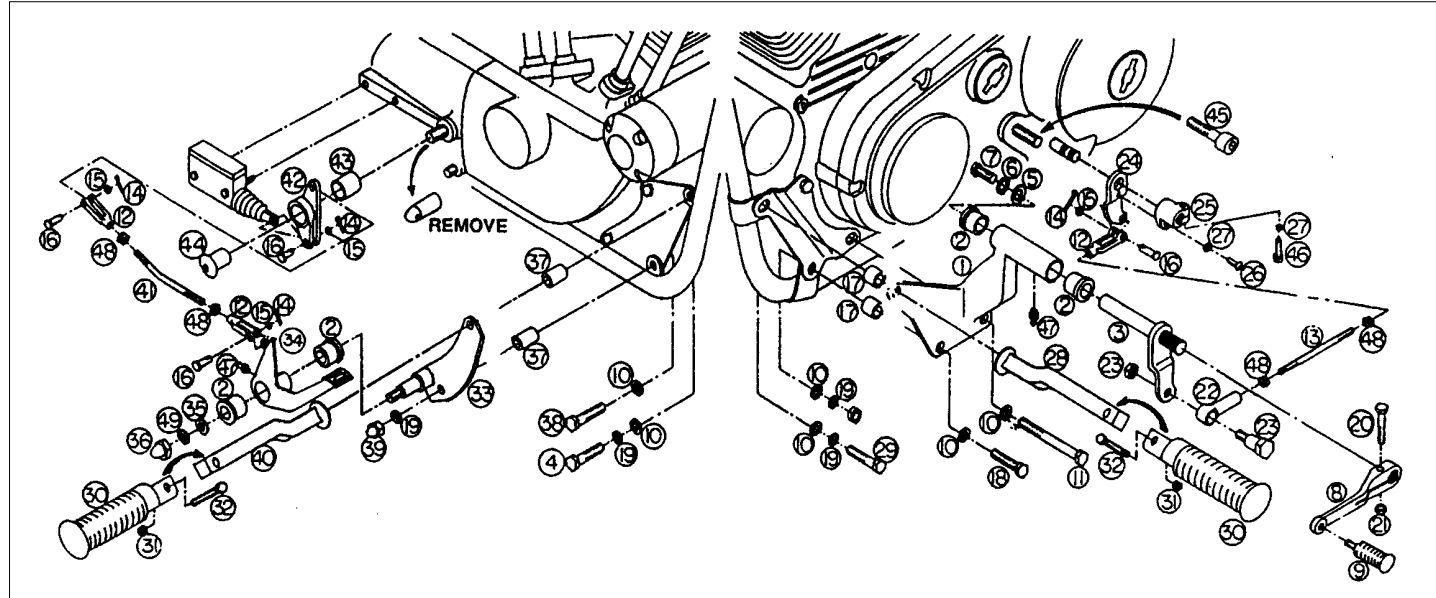

NOTE: Use blue Loctite on first three threads of all hardware!

Pos.	Qty.	Description	ZPN	Pos.	Qty.	Description	ZPN
1	1	Shift lever support	056048	26	1	Button head screw 1/4-20 X 5/8	345223
2	4	Bushing	056064	27	2	1/4 Lockwasher	233241
3	1	Shift lever shaft	056063	28	1	Footpeg mount left	056071
4	1	Hex bolt 3/8-24 X 2 3/4	-	29	1	Hex bolt 3/8-24 X 1 3/4	236566
5	1	5/16 Flatwasher	233245	30	2	Foot peg	-
6	1	5/16 Lockwasher	233242	31	2	Nylock nut 1/4-20	233315
7	1	Hex bolt 5/16-18 X 3/4	233257	32	2	Hex bolt 1/4-20 X 1 1/4	236524
8	1	Shift lever	-	33	1	Brake mounting bracket	056059
9	1	Shift lever pedal	-	34	1	Brake pedal	056078
10	6	3/8 Flatwasher	238248	35	1	Flatwasher special 1/2	-
11	1	Hex bolt 3/8-24 X 5 1/2	-	36	1	Acorn 1/2-20	345201
12	3	Clevis	056065	37	2	Spacer long	345226
13	1	Shift rod	056049	38	1	Hex bolt 3/8-24 X 2 1/2	-
14	4	1/16 Dia cotter pin	-	39	1	Acorn nut 3/8-24	233210
15	4	1/4 Flatwasher	238246	40	1	Footpeg mount right	-
16	4	Clevis pin	-	41	1	Brake rod	056016
17	2	Spacer short	346221	42	1	Bell crank	-
18	1	Hex bolt 3/8-24 X 2	233270	43	1	Bushing	-
19	5	3/8 Lockwasher	233243	44	1	Special nut 1/2-13	-
20	1	Hex bolt 5/16-24 X 1 1/4	233260	45	1	Special bolt 1/2-13 X 3	-
21	1	Nylock nut 5/16-24	233318	46	1	Hex bolt 1/4-20 X 1	236523
22	1	Rod end	056066	47	2	Grease fitting	-
23	1	Shoulder bolt & nut	056067	48	4	Hex jam nut 5/16-24	-
24	1	Adapter lever	056068	49	1	1/2 Lockwasher	238257
25	1	Adapter shift lever	056069				

NOTE: When no Zodiac Partnumber is listed the part is available upon special order only!

NOTE: Use blue Loctite on first three threads of all hardware

- Block motorcycle securely into position in order to have easy access to hardware related to this conversion
- Remove exhaust pipes and mufflers and set aside
- Assemble shift lever support (1). Insert both bushings (2), slide shift lever shaft into support and secure with washer (5), lock washer (6), and bolt (7).
- Undo left front motor mount bolts from frame and remove case bolt that attaches lower portion of mount to engine (upper case bolt need not to be touched)
- Using case bolt (11) and flat washer (10) provided, assemble shift lever support into position loosely, then, using hex bolt (18), and flat washer (10), on front side and spacer (1), behind support in lower frame mounting position, install flat washer (10) and lock washer (19) and existing nut. Place clutch cable clamp (if one is present) on front side over end of hex bolt (29), and thread on left foot peg mount, until snug.
- Install foot peg (30), onto left foot peg mount (28) using hex bolt (32), and locknut (31) and, after proper positioning securely tighten all hardware mentioned in step {5}
- Remove original shift lever and foot peg from its mount. Foot peg mount stud can be removed by double nutting. The shifting hole can be covered with the installation of special bolt (45).
- Slide adapter lever (24), over shift shaft splines as oriented in illustration and slide adapter shift lever (25) onto spline at the lowermost hole in lever is directly below in line with spline shaft. Using screw (26) and lock washer (27), secure (24) to (25). Tighten unit to spline using bolt (46) and lock washer (27).
- Assemble shift rod (13) using clevis (12) and nut (48) on one end, and rod end (22) and nut (48) on other end. Do not tighten nuts yet and leave about 1/4 of thread showing on each end.
- Using shoulder bolt and nut (23), install shift rod onto shift lever shaft lower ear. Assemble other end of shift rod onto adapter lever (24), by using clevis pin (16), washer (15) and cotter pin (14).
- Shift lever (8) can now be installed onto shift lever shaft (3), and after proper positioning (allowing full up and down movement) secure it using bolt (20) and locknut (21). Clevis and rod end lock nuts can now be tightened. Left side of motorcycle is now completed.
- Remove foot peg and brake lever from mounting shaft on transmission sprocket cover. Remove sprocket cover from motorcycle and unscrew the brake lever mounting shaft. Using original bolt, install bell crank (42), as per illustration using special nut (44) and bushing (43). Tighten securely and reinstall transmission sprocket cover.
- Remove right side motor mount bolts (the two that connect to the frame) and install brake mounting bracket (33), using two bolts (4) and (38), one lock washer (19), two flat washers (10), and two spacers (37) behind bracket and using acorn nut (39), and one lock washer (19), on lower bolt and right side foot peg mount (40) on upper bolt. Assemble foot peg (30) to mount (40) with bolt (32) and locknut (31). Position foot peg properly and tighten entire assembly securely.
- Press bushing (2), into brake lever (34) and slide lever onto bracket shaft (33). Tighten with special flat washer (35), lock washer (49), and acorn nut (36).
- Assemble brake rod (41) with clevis (12) and nuts (48) on both ends so that about 1/2" of thread is still visible. Using clevis pins (16), flat washers (15), and cotter pin (14), connect brake lever (34) and bell crank (42) with assembled brake rod that has long end facing towards front of bike. Test pedal action and clearance. If correct, tighten nuts (48) securely.
- Reinstall exhaust pipes.

NOTE: Bike should be carefully test ridden at low speed to make sure it is operating correctly, before open road use