

056080

FORWARD CONTROL KIT FOR 5 SPEED SPORTSTER MODELS

MOUNTING INSTRUCTIONS

FOR SPORTSTER 5 SPEED FORWARD CONTROL KIT ZPN 056080

1. Block motorcycle securely into position. Make sure you have easy access to hardware relative to this conversion
2. Remove exhaust pipes and mufflers
3. Assemble shift lever support (1) by installing both bushings (2) and grease fitting (47) slide shift lever shaft (3) into support and secure with washer (5), lock washer (6), and bolt (7).
4. Undo left front motor mount bolts from frame and remove case bolt that cinches lower portion of mount to engine (upper case bolt need not to be touched)
5. Using case bolt (11) and flat washer (10) provided, assemble shift lever support into position loosely, then, using hex bolt (18), and flat washer (10), on front side and spacer (1), behind support in lower frame mounting position, install flat washer (10) and lock washer (19) and existing nut. Place clutch cable clamp (if one is present) on front side over end of hex bolt (29), and thread on left foot peg mount, until snug.
6. Install foot peg (30), onto left foot peg mount (28) using hex bolt (32), and lock nut (31), after proper positioning securely tighten all hardware mentioned in step 5.
7. Remove original shift lever and foot peg from its mount. Replace foot peg mount bolts with shorter socket head screw (50). Slide transmission lever (25) onto splined shaft with lower hole directly below splines. Tighten lever to spline using bolt (46) and lock washer (27).
8. Assemble shift rod (13) using clevis (12) and nut (48) on one end, and rod end (22) and nut (48) on other end. Do not tighten nuts yet and leave about 1/4" of thread showing on each end.
9. Using shoulder bolt and nut (23), install shift rod onto shift lever shaft lower ear. Assemble other end of shift rod on-to adaptor lever (24), by using clevis pin (16), washer (15) and cotter pin (14).
10. Shift lever (8) can now be installed onto shift lever shaft (3), and after proper positioning (allowing full up and down movement) secure it using bolt (20) and lock nut (21). Clevis and rod end lock nuts can now be tightened. Left side of motorcycle is now completed.
11. Remove two bolts, brake line clip, and clevis pin securing master cylinder to sprocket cover. Master cylinder can now be swung clear and sprocket cover removed. Loosen nut from peg mount and remove peg, mount, and brake lever.
12. Insert spacer (24) and bolt (45) thru sprocket cover. Install bell-crank (42) as per illustration, using special nut (44) and bushing (43). Tighten securely and install sprocket cover and master cylinder. Connect bell-crank to master cylinder using clevis pin (16), washer (15), and cotter pin (14).
13. Remove right side motor mount bolts (the two that connect to the frame) and install brake mounting bracket (33), using two bolts (4) and (38), one lock washer (19), and two spacers (37) behind bracket and using acorn nut (39), and one lock washer (19), on lower bolt and right side foot peg mount (40) on upper bolt. Assemble foot peg (30) to mount (40) with bolt (32) and lock nut (31). Position foot peg properly and tighten entire assembly securely.
14. Install bushing(2) and grease fittings (47), into brake lever (34) and slide lever onto bracket shaft (33). Cinch with special flat washer (35), lock washer (49), and acorn nut (36).
15. Assemble brake rod (41) with clevises (12) and nuts (48) on both ends so that about 1/2" of thread is still visible. Using clevis pins (16), flat washers (15), and cotter pin (14), connect brake lever (34) and bell-crank (42) with assembled brake rod that has short end facing towards front of bike. Test pedal action and clearance. If correct, cinch nuts (48) securely.
16. Reinstall exhaust pipes.

NOTE 1: Test ride the bike at slow speed to make sure everything is working correctly, before open road use.

Note: Use blue Loctite on the first three threads of all hardware.

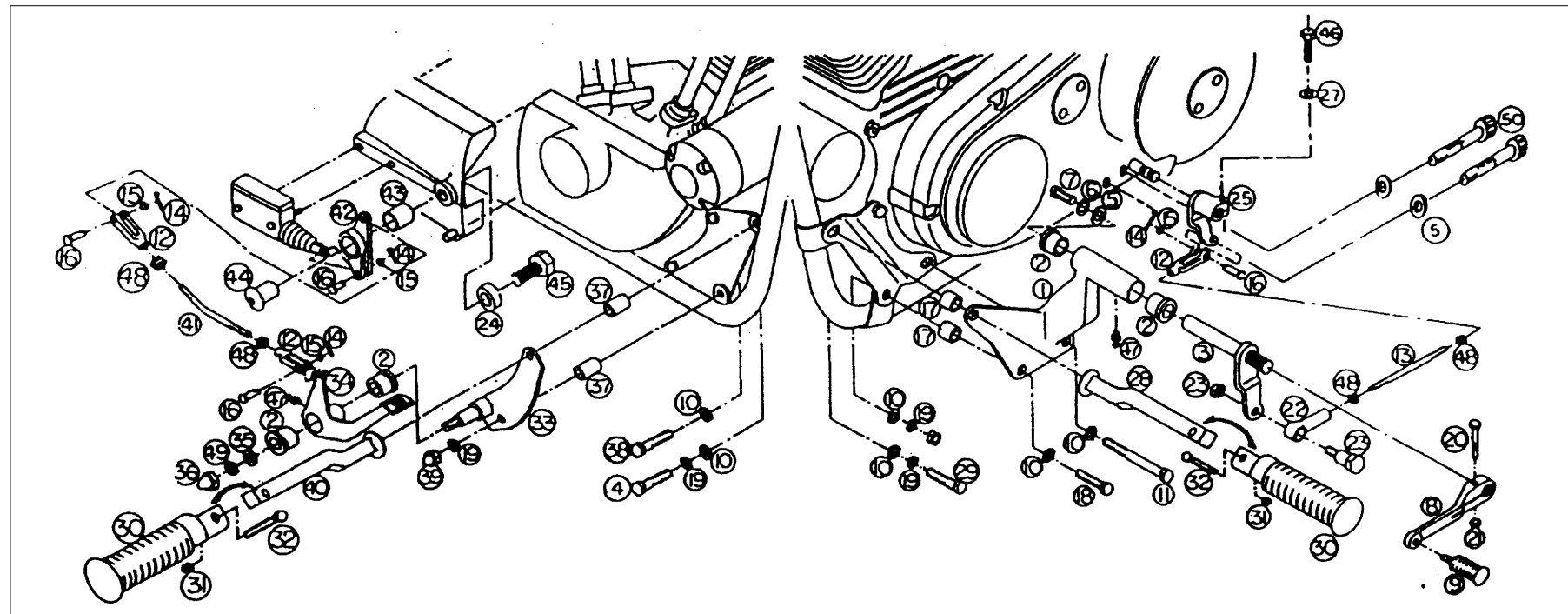

BILL OF MATERIAL

NO	QTY	DESCRIPTION	NO	QTY	DESCRIPTION	NO	QTY	DESCRIPTION
1	1	Shift lever support	17	2	Spacer short	35	1	Flat washer special 1/2"
2	4	Bushing	18	1	Hex Bolt 3/8"-24 x 2"	36	1	Acorn nut 1/2"-20
3	1	Shift lever shaft	19	5	3/8" Lock washer	37	2	Spacer long
4	1	Hex bolt 3/8"-24 x 2 3/4"	20	1	Hex bolt 5/16"-24 x 1 1/4"	38	1	Hex bolt 3/8"-24 x 2 1/2"
5	3	5/16" Flat washer	21	1	Nylock nut 5/16"-24	39	1	Acorn nut 3/8"-24
6	1	5/16" Lock washer	22	1	Rod end	40	1	Foot peg mount right
7	1	Hex bolt 5/16"-18 x 3/4"	23	1	Shoulder bolt & nut	41	1	Brake rod
8	1	Shift lever	24	1	Adapter lever	42	1	Bell crank
9	1	Shift lever pedal	25	1	Adapter shift lever	43	1	Bushing
10	6	3/8" Flat washer	26			44	1	Special nut 1/2"-13
11	1	Hex bolt 3/8"-24 x 5 1/2"	27	1	1/4" Lock washer	45	1	Hex bolt 1/2"-13 x 3"
12	3	Clevis	28	1	Foot peg mount left	46	1	Hex bolt 1/4"-20 x 1"
13	1	Shift rod	29	1	Hex bolt 3/8"-24 x 1 3/4"	47	2	Grease fitting
14	4	1/16" Dia. cotter pin	30	2	Foot peg	48	4	Hex jam nut 5/16"-24
15	4	1/4" Flat washer	31	2	Nylock nut 1/4"-20	49	1	1/2" Lock washer
16	4	Clevis pin	32	2	Hex bolt 1/4"-20 x 1 1/4"	50	2	5/16"-18 x 2 3/4" Allen bolt chrome
			33	1	Brake mounting bracket			
			34	1	Brake pedal			