

301739

CHROME TAPPET BLOCK COVER SET FOR 1953 - 1984 PANHEAD AND SHOVELHEAD BIG TWINS

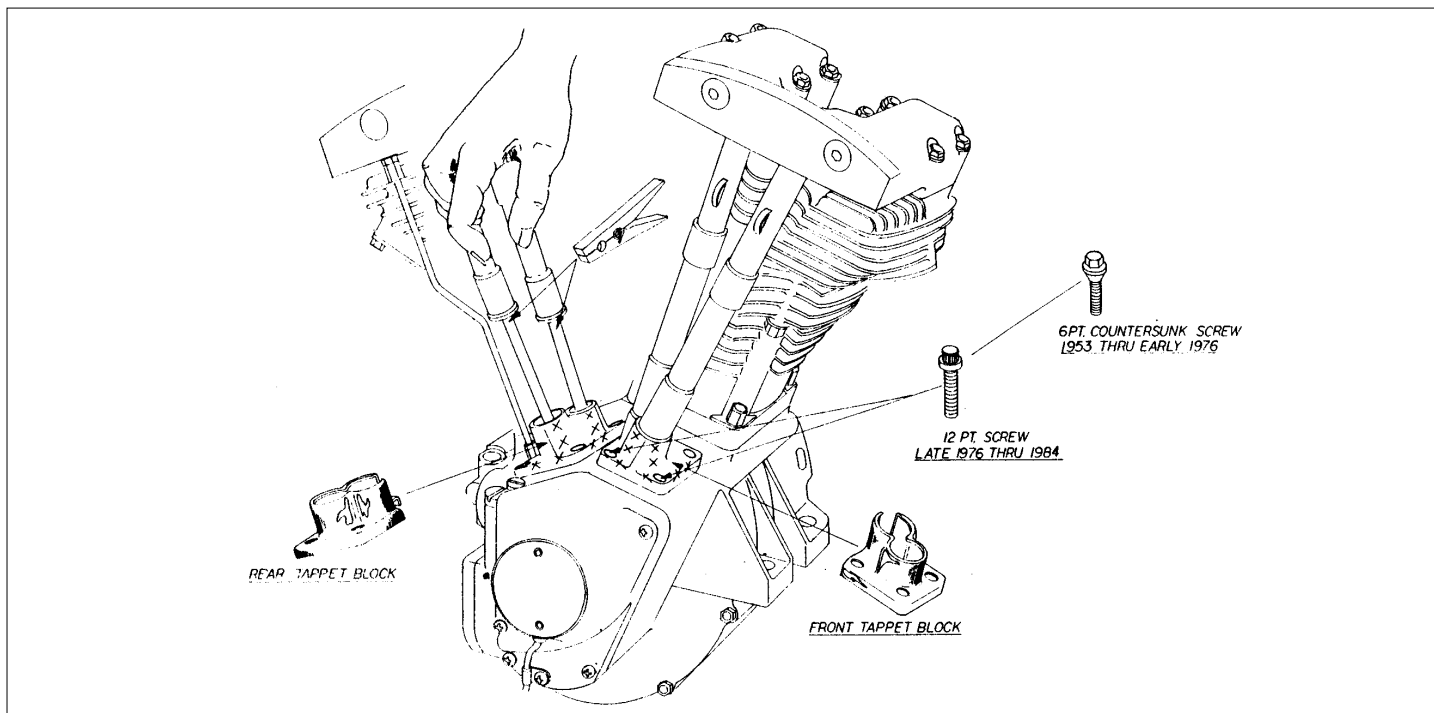

Note: These covers will not work on late 1981 - early 1982 models with tappet block breather fittings installed.

1. Installation must be performed on a cold engine. We recommend installing these covers in the evening, permitting the silicone adhesive used in step 6 to cure overnight before engine start-up.
2. Clean outside of tappet guides and pushrod tubes to remove any oil, dirt, or grease using degreaser. Allow to dry completely.
3. Remove air cleaner to permit easy access to pushrod tubes.
4. One at a time, remove the existing tappet guide screws and replace them with the appropriate chrome screws (6-point counter sunk screws for models from 1953 - early 1976, and 12-point screws for models from late 1976 thru 1984).
5. Remove all four pushrod tube retaining clips and raise the pushrod tubes a few inches above the tappet blocks as illustrated. We recommend using four spring-type clothes pins to hold tubes up, out of the way. Any oil which leaks onto the tappet guides must be cleaned completely away.
6. Using silicone adhesive provided, put smooth, even 1/4"-long beads on the tappet guides where illustrated with an "XX". Do not use an excess, only a small amount is required.
7. Carefully install covers by sliding cover slot around pushrods. Gently push both covers down unto tappet guides as far as possible.

Note: Chrome tappet guide screws should protrude through holes in covers.

8. Pass pushrod tubes into tappet guides, through cover openings. Reinstall tube clips and check for a good tube seal.
9. Clean away any excess silicone that may have squeezed out during installation.
10. Reinstall air cleaner assembly.
11. Allow motorcycle to sit cold for 12 hours (overnight) to permit silicone to cure before start up.