

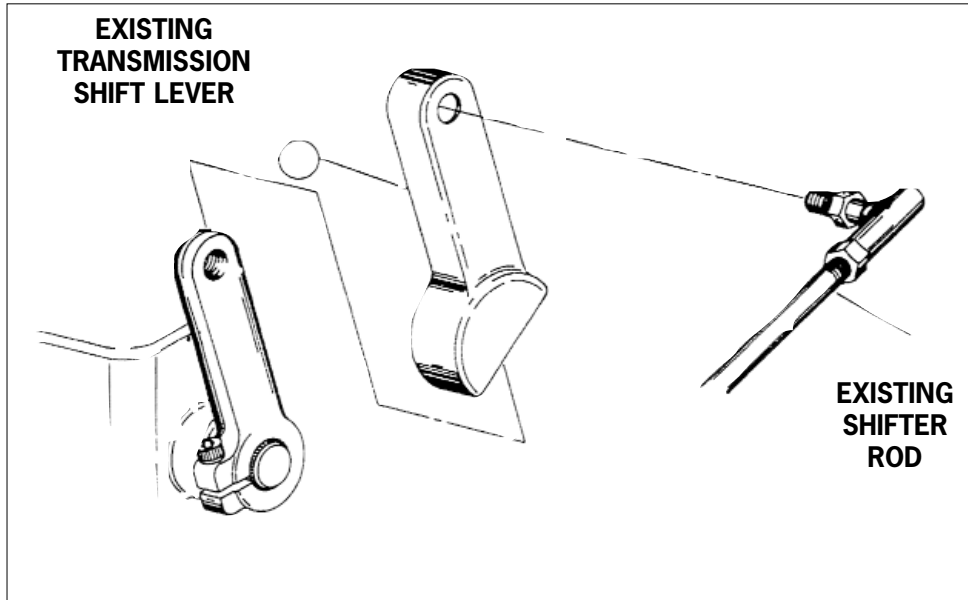

# 301888

## Chrome Transmission Shift Lever Cover for 5-Speed Big Twin Models 1985 to present



### NOTES FOR INSTALLATION:

1. Remove Shifter Rod from Transmission Shift Lever Assembly.
2. Slip Transmission Shift Lever Cover over Shiftlever (as shown in illustration).
3. Align hole in Cover to the Shift Lever's threaded hole and attach Shifter Rod.



# 301888

## Chrome Transmission Shift Lever Cover for 5-Speed Big Twin Models 1985 to present

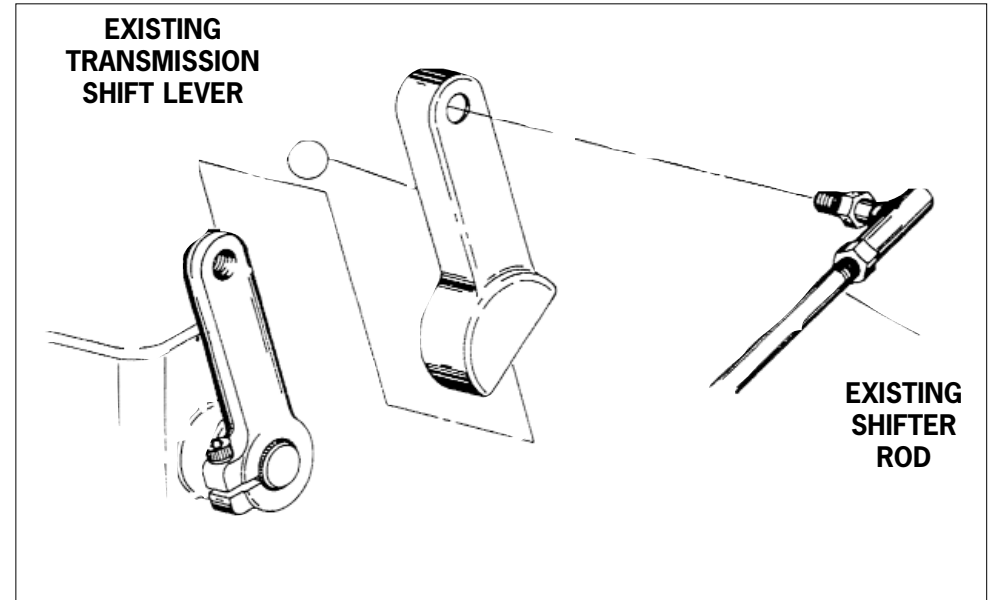

### NOTES FOR INSTALLATION:

1. Remove Shifter Rod from Transmission Shift Lever Assembly.
2. Slip Transmission Shift Lever Cover over Shiftlever (as shown in illustration).
3. Align hole in Cover to the Shift Lever's threaded hole and attach Shifter Rod.