

361570

ADJUSTABLE PASSENGER FOOTPEG KIT

FXR 1982 AND UP, FLSTC 1990 AND UP

BILL OF MATERIAL

Nr.	Qty.	Description
1	2	Female star mount
2	2	Offset dog bone
3	2	Male star mount
4	2	Mount FXR/FLST
5	4	1/16-20 UNF x 1.00" long socket head screw
6	4	5/8 UNC x 1.50" long socket head screw
7	4	5/8-16 UNC Nyloc nut
8	4	Flat spring
9	1	1/2 I.D. x 3/8 wide spacer

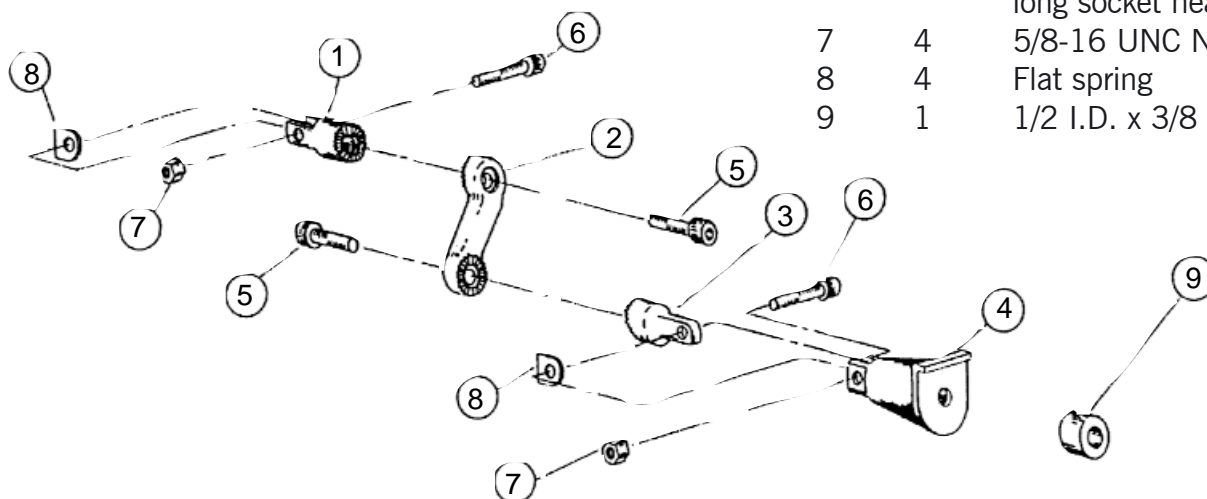

NOTE: Use blue Loctite on all hardware

1. Remove existing footpegs and peg mounts, retaining all hardware.
 - 2A. For ZPN 361569, install passenger mount (4) to frame using original 1/2" bolt and lockwasher. Tighten securely.
 - 2B. When installing ZPN 361570 on FXRS models, install mount (4) with tab upward using 1/2" bolt and lockwasher. Tighten securely.
 - 2C. When installing ZPN 057047 on 1990 and up FLSTC, using ZPN 233558 relocation kit, install brackets with spacers (9) between bracket and frame. Secure mounts and bracket using provided 1/2" bolt and lockwashers. Tighten securely.
 3. Install male star mount (3) into female mount by placing spring (8) into clevis and pushing male star in as shown. Secure using 7/16" bolt (6) and locknut (7).
 4. Loosely install female star (1) mount to offset dog bone (2) using 3/8" bolt.
 5. Install offset dog bone to male star mount using 3/8" bolt (5), position dog bone as desired and tighten securely.
- NOTE: All intended peg locations must be checked for ground and accessorie clearances. ZODIAC strongly recommends a miniumum 9" ground clearance for all possible cornering angles.**
6. Route female star mount to position slot vertical to slightly rearward. Tighten securely.
 7. Install existing peg by positioning spring (8) in slot and pushing peg in. Secure with 7/16" bolt (6) and lock nut (7).
 8. Re-check all hardware and clearances before test driving.