



361571

ADJUSTABLE FRONT FOOTPEG KIT

BILL OF MATERIAL

| Nr. | Qty. | Description |
|-----|------|---|
| 1 | 2 | Female star mount |
| 2 | 2 | Straight dog bone |
| 3 | 2 | Male star mount |
| 4 | 4 | 7/16-20 UNF x 1.00" long socket head screw |
| 5 | 4 | 3/8-16 UNC x 1.50" long socket head screw |
| 7 | 4 | 3/8-16 UNC Nyloc nut |
| 8 | 4 | Flat spring |

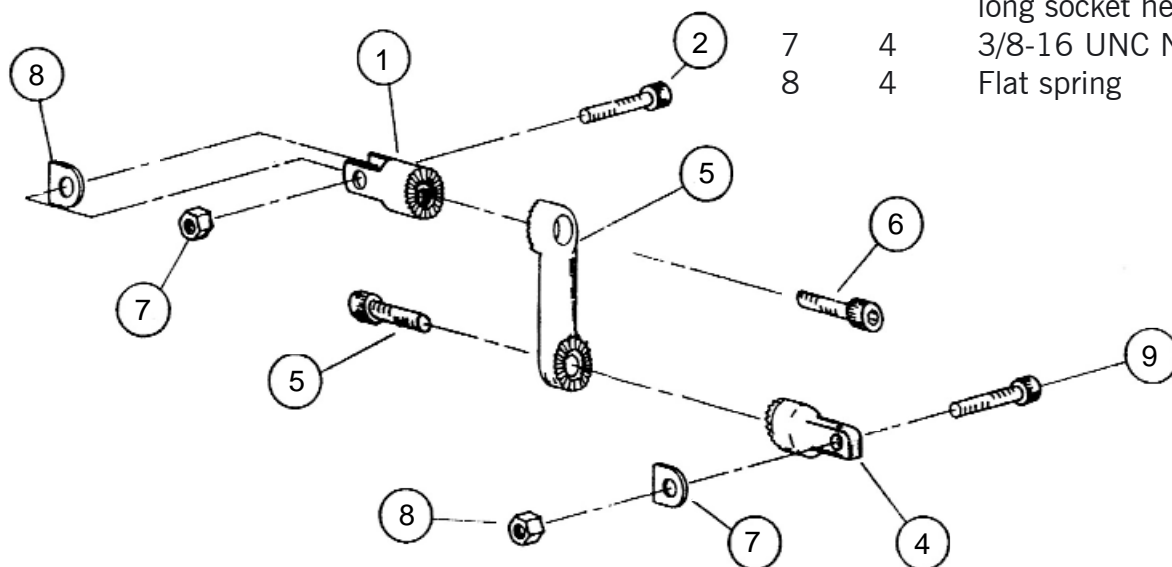

NOTE: Use blue Loctite on all hardware

1. Remove existing footpegs retaining all hardware.
2. Install male star mount (3) into existing front female mount by placing spring (8) into clevis and pushing male star in as shown. Secure using 7/16" bolt (6) and locknut (7).
4. Loosely install female star (1) mount to straight dog bone (2) using 3/8" bolt.
5. Install straight dog bone to male star mount using 3/8" bolt (5), position dog bone as desired and tighten securely.
NOTE: All intended peg locations must be checked for ground and accessorie clearances. ZODIAC strongly recommends a miniumum 9" ground clearance for all possible cornering angles.
6. Route female star mount to position slot vertical to slightly rearward. Tighten securely.
7. Install existing peg by positioning spring (8) in slot and pushing peg in. Secure with 7/16" bolt (6) and lock nut (7).
8. Re-check all hardware and clearances before test driving.