

150035

STARTER SOLENOID REPAIR KIT

FOR ALL MODELS 1965-1988 (EXCEPT 1981-1988 XL MODELS)

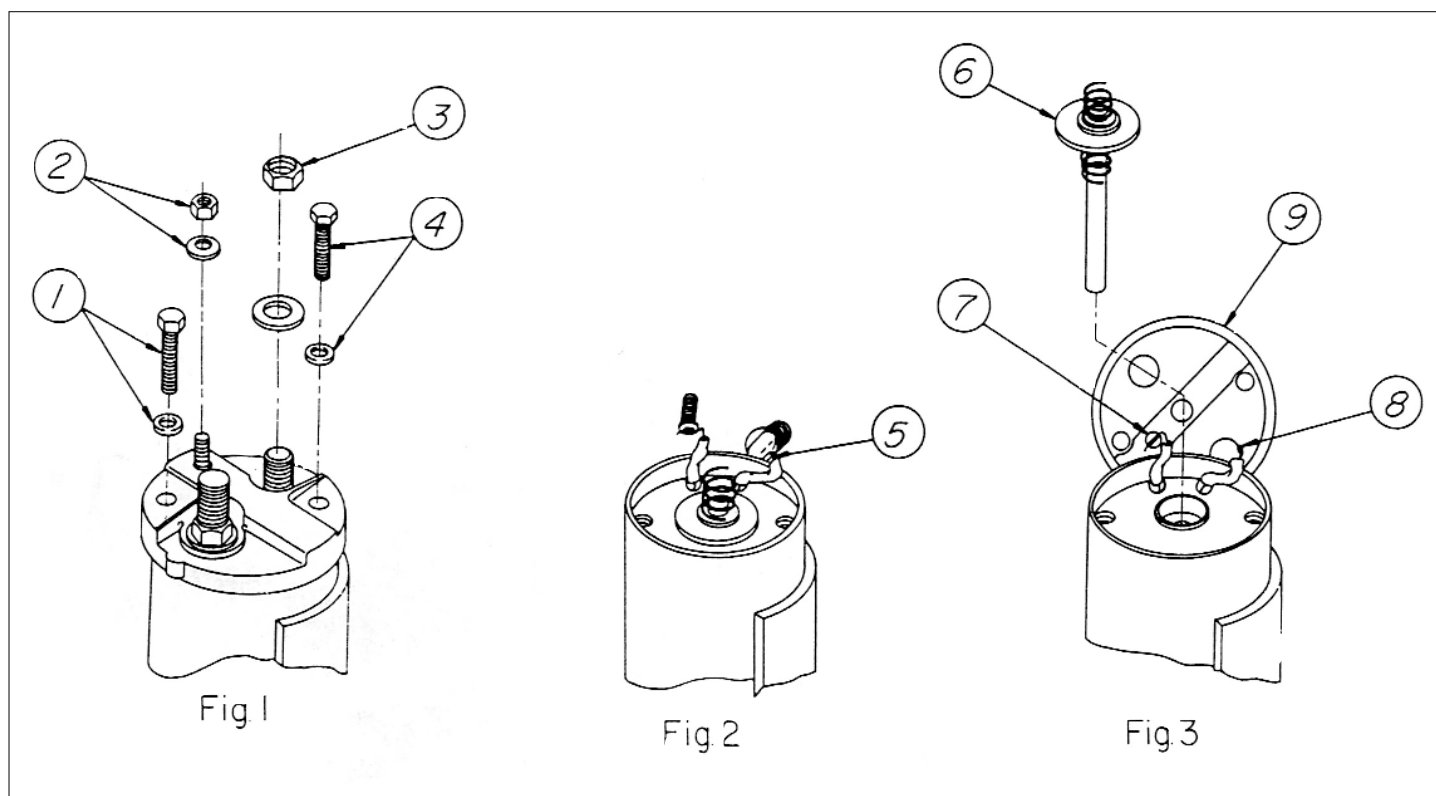

1. Remove, but do NOT discard, bolt washer **1** and **4** (fig. 1).
2. Remove, but do NOT discard, nut washer **2** (fig. 1).
3. Remove, but do NOT discard, nut washer **3** from shortest copper bolt on cap (fig. 1).
4. Gently remove solenoid cap.
5. **IMPORTANT!**: Snip wire **5** as close as possible to large copper bolt (fig. 2).
6. Discard old copper bolt and cap.
7. Replace old plunger **6** with new plunger provided in kit.
8. Guide small bolt **7** through hole in new cap as shown (fig. 3).
9. Solder cut wire **5** to new copper bolt terminal **8** **CAUTION!**: Solder wire to terminal, so as not to interfere with contact of plunger to terminal.
10. Install new cap.
11. Re-assemble nuts, bolts and washers **1 2 3 4** as shown (fig. 1). Replace worn parts with those provided in kit.