

LED TURN SIGNALS ON CAN BUS MODELS

CAN bus electrical systems are found on all 2011 to present Softails, 2012 to present Dynas, 2014 to present Sportsters, and 2014 to present Touring and Tri-Glide models. CAN bus motorcycles can be identified by the hazard (4-ways) button located on the brake-side (right) hand controls as pictured below:



IMPORTANT: Load equalizers are **NOT** necessary on CAN bus systems when LED Turn Signal Inserts are installed.

Installation and check procedure:

STEP 1 Start the bike and check for proper turn signal operation. If the turn signals flash rapidly on CAN bus system bikes, you will need to synchronize the turn signal system. Follow the procedure below to synchronize:

Turn the ignition **ON**,

Turn on the 4-way flashers for at least 20 seconds; shut the 4-way flashers off,

Turn the ignition **OFF**,

Turn the ignition back **ON**; check for proper turn signal operation,

You may need to repeat the procedure if the signals still flash rapidly.

NOTE: Diagnostic Trouble Codes (DTC) may be triggered during initial startup when using LED Turn Signal Inserts. Follow the below procedure on to check and clear DTCs.

CLEARING DIAGNOSTIC TROUBLE CODES (DTCs)—CAN BUS MODELS:

NOTE: Before clearing any codes, confirm that the LED Turn Signal Inserts illuminate and flash correctly.

Refer to PICs 5, 6 and 7. To enter diagnostic mode, press and hold the trip odometer reset switch located on the left handlebar control, while turning the **IGN ON**.

Release the trip odometer reset switch when "DIAG" appears on the **ODOMETER DISPLAY**.

Press and release the trip odometer reset switch until "BCM" is displayed on the odometer display. "BCM Y" = Yes DTC set. "BCM N" = No DTC set. If "BCM Y" is displayed, press and hold the trip odometer reset switch. If any DTC's (diagnostic trouble codes) are stored in the module, the odometer will display the DTC. Quickly pressing and releasing the trip odometer reset switch will cycle through the stored DTCs. When all the DTCs have been cycled the odometer will display "END". Continue to quickly press and release the trip odometer reset switch to cycle through the DTCs again.

NOTE: The **ONLY** DTCs you will be clearing are as follows:

- b2141 Left front turn signal output open
- b2146 Right front turn signal output open
- b2151 Left rear turn signal output open
- b2156 Right rear turn signal output open

To clear the DTCs listed above, press and hold the trip odometer reset switch **while the DTC is displayed** until "CLEAR" appears on odometer display. Press and release the trip odometer reset switch again to continue to the next module. Repeat for **any other code listed above**. Turn the **IGN OFF** to exit the diagnostic mode. Wait for any security lights to flash and repeat the procedure to ensure that the DTCs have been cleared.

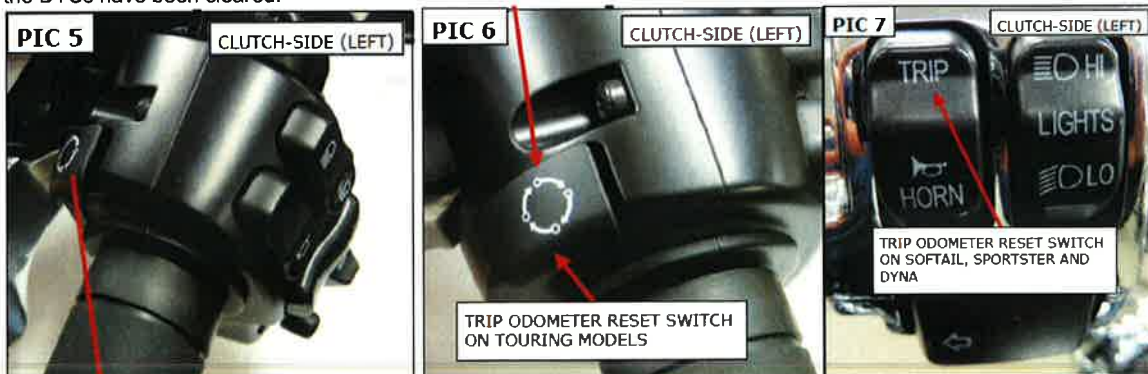

Pictures and text courtesy of Kuryakyn